

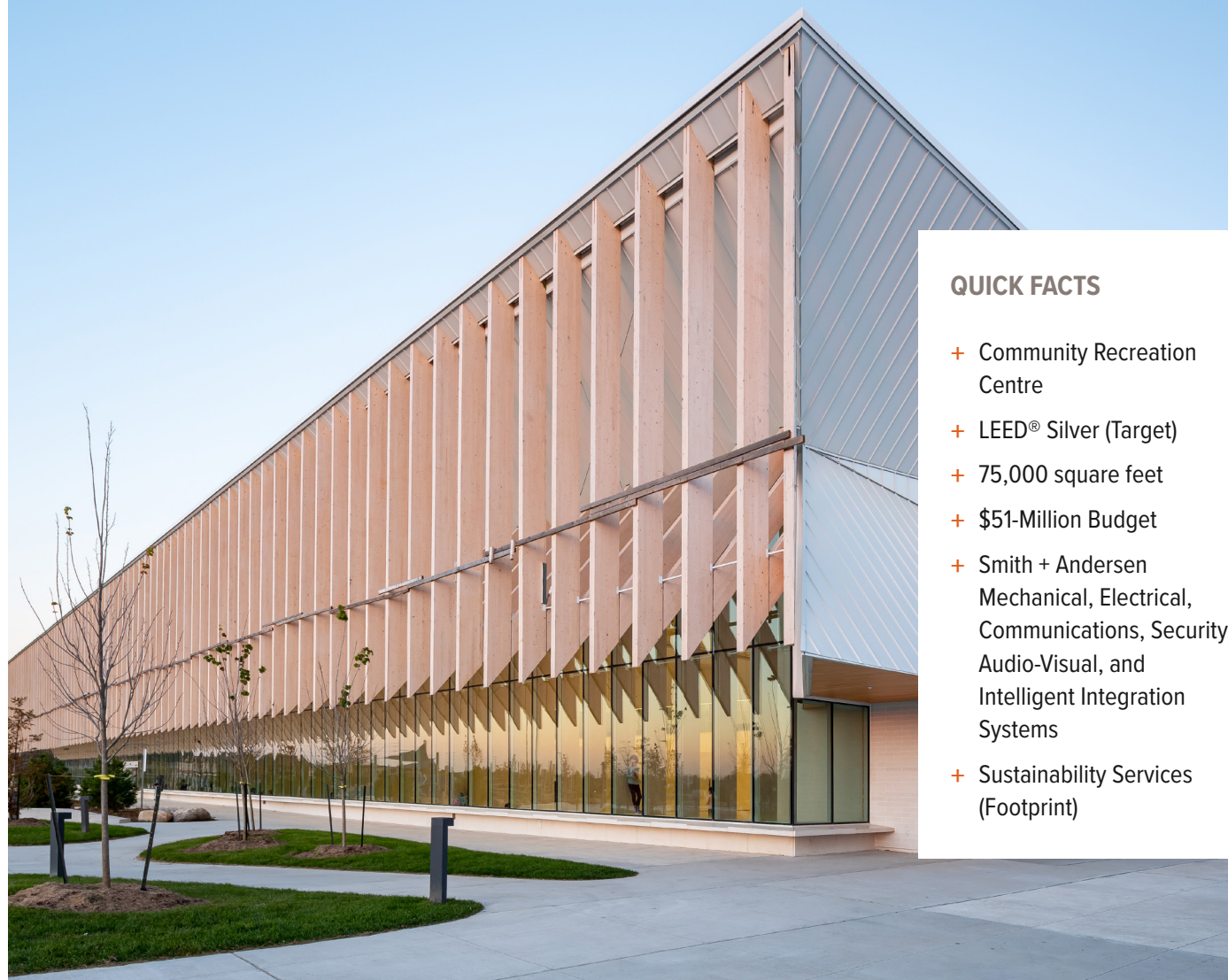

CHURCHILL MEADOWS RECREATION CENTRE

MISSISSAUGA, ON



QUICK FACTS

- + Community Recreation Centre
- + LEED® Silver (Target)
- + 75,000 square feet
- + \$51-Million Budget
- + Smith + Andersen Mechanical, Electrical, Communications, Security, Audio-Visual, and Intelligent Integration Systems
- + Sustainability Services (Footprint)

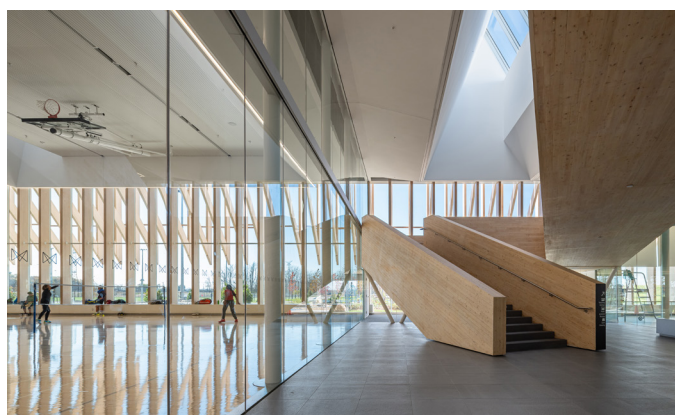



CHURCHILL MEADOWS RECREATION CENTRE

ABOUT THIS PROJECT

- + Two-storey community recreation centre includes a triple-gymnasium, a 25-metre six-lane pool and therapy pool, a teaching kitchen, as well as various meeting and gathering spaces.
- + Outdoor amenities include two lit, artificial turf soccer fields, seasonal dome, splash pad, skate park, and basketball court.
- + The 75,000 building is surrounded by 55 acres of green space and surrounding park amenities are strategically placed close to the building to centralize gathering spaces.
- + Smith + Andersen worked alongside the architect during and after the virtual planning process. Revit coordination played a large part in the success of this project due to the extensive amount of service infrastructure and unique ceiling designs.
- + Building and landscape work in tandem not only aesthetically but functionally as the project team purposefully navigated challenges posed by a protected wetland environment.
- + The mass timber framing reduces the carbon footprint of the building and provides a deep overhang on west facade to reduce solar heat gain.

LOCATION

Mississauga, ON

SMITH + ANDERSEN SERVICES PROVIDED

Mechanical, Electrical, Communications, Security, Audio-Visual, Intelligent Integration Systems, Sustainability (Footprint)

KEY TEAM MEMBERS

MJMA Architect
Blackwell Structural Engineers

SIZE

75,000 sq. ft. (7000 sq. m.)

BUDGET

\$51 Million

COMPLETION YEAR

2021

SUSTAINABILITY

LEED® Silver (Target)

HOT BUTTONS

MECHANICAL

COMMUNITY

RECREATION

SUSTAINABLE

PUBLIC SPACES

LEED

AQUATICS

ELECTRICAL

